

12" UNTOPPED

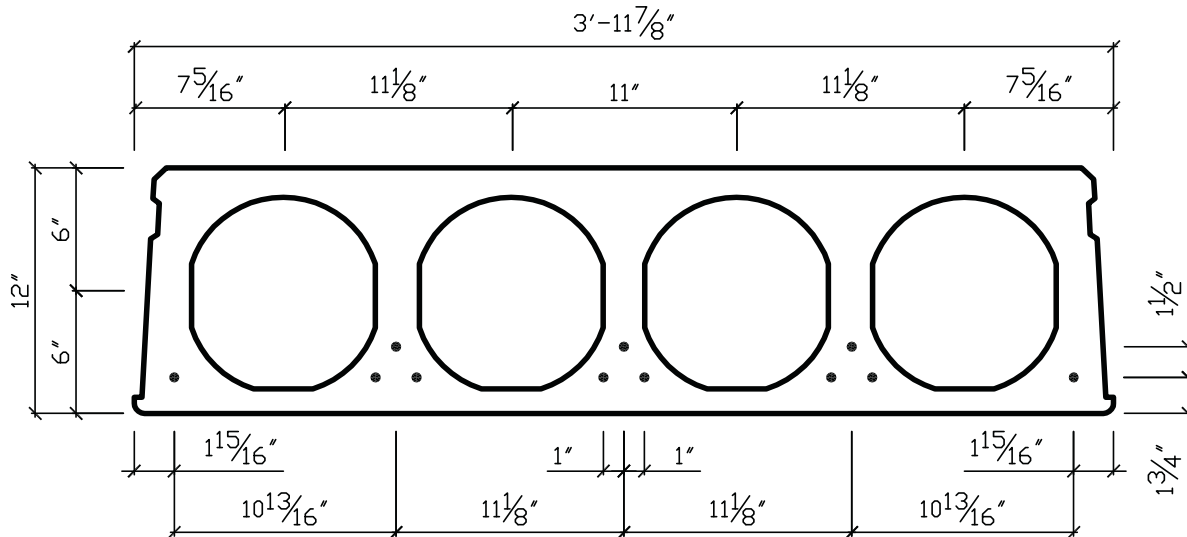

SECTION PROPERTIES (NORMAL WEIGHT CONCRETE)

A = 279 in.² Wt. = 74 psf
 I = 5104 in.⁴ f'c = 6000 psi

MAXIMUM UNIFORMLY DISTRIBUTED SUPERIMPOSED SERVICE LOAD IN PSF															
Strand Pattern	Span in Feet (center to center of bearing)														
(1/2" ø 270 ksi LL Strand)	32'	33'	34'	35'	36'	37'	38'	39'	40'	41'	42'	43'	44'	45'	46'
lbs per square foot	159	153	146	141	135	130	126	121	117	113	104	99	96	92	89



12" TOPPED

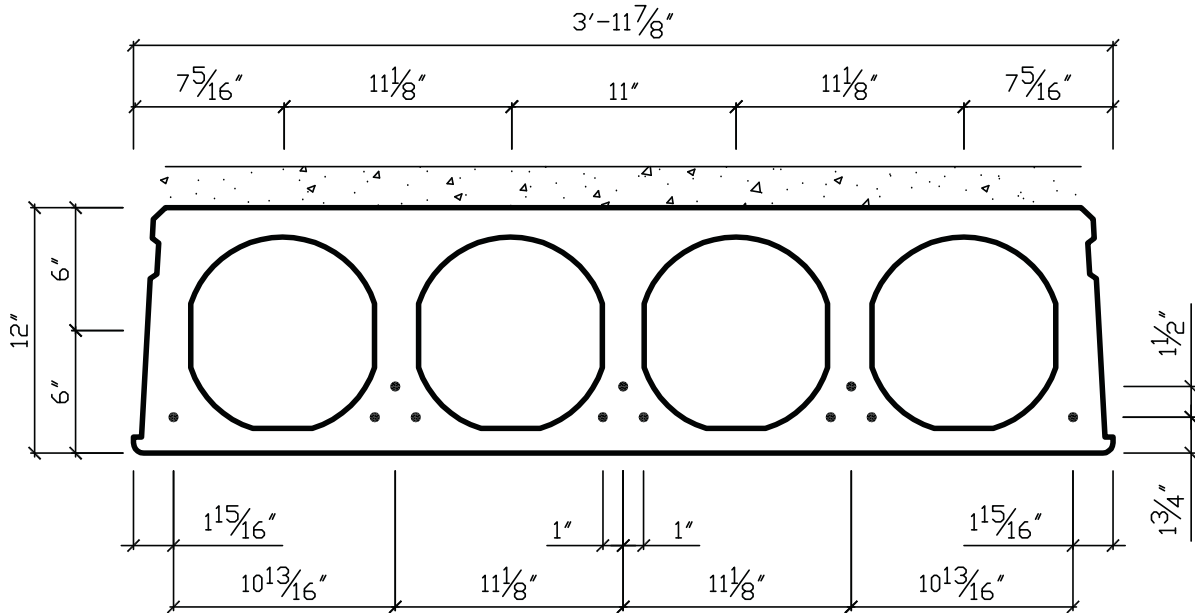

SECTION PROPERTIES (NORMAL WEIGHT CONCRETE)

$A_c = 363.6 \text{ in.}^2$ $f'_c = 6000 \text{ psi}$
 $I_c = 8133 \text{ in.}^4$ $f'_c \text{ Topping} = 3000 \text{ psi}$

MAXIMUM UNIFORMLY DISTRIBUTED SUPERIMPOSED SERVICE LOAD IN PSF															
Strand Pattern	Span in Feet (center to center of bearing)														
(1/2" \varnothing 270 ksi LL Strand)	32'	33'	34'	35'	36'	37'	38'	39'	40'	41'	42'	43'	44'	45'	46'
lbs per square foot	181	174	166	160	153	147	141	134	124	120	115	111	107	103	99

